

Nutenstein

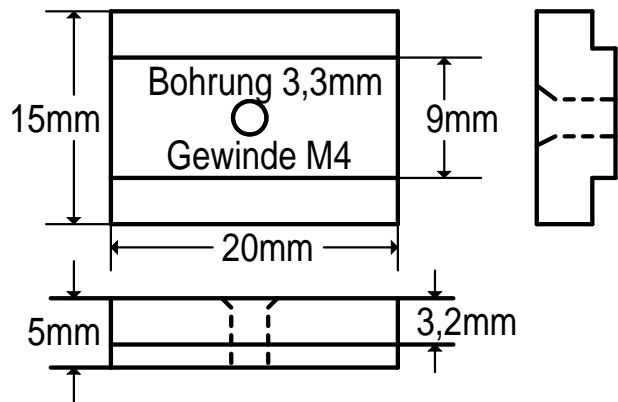

Alu-Rohr D= 8mm

Wandstärke 1mm

25mm

Gegenplatte Nutenstein

Bohrung 4mm

18mm

20mm

37mm

Bohrung 3mm

12mm

Bohr.

2,3mm

6mm

1,5mm Alublech

5mm

4mm

Niederhalter

Haltewinkel ZD-127-Lupenleuchte

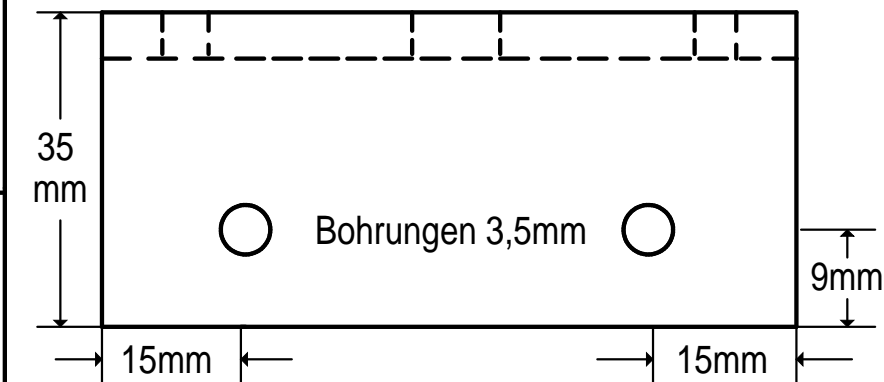
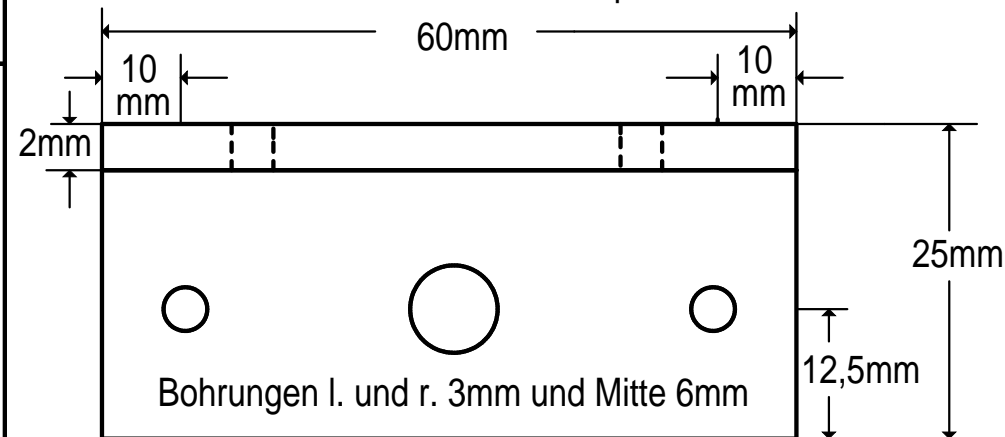

Ausleger

87mm

2mm

Bohrungen 4mm

12mm

Bohrung 3mm

6mm

20mm

30mm

10mm

PMW2026 Poor Man's Workbench

Einzelteile aus Aluminium

DL50AU, 12/25